

PHOTOELECTRIC DUAL BEAM DETECTOR

Manual

1 PARTS DESCRIPTION

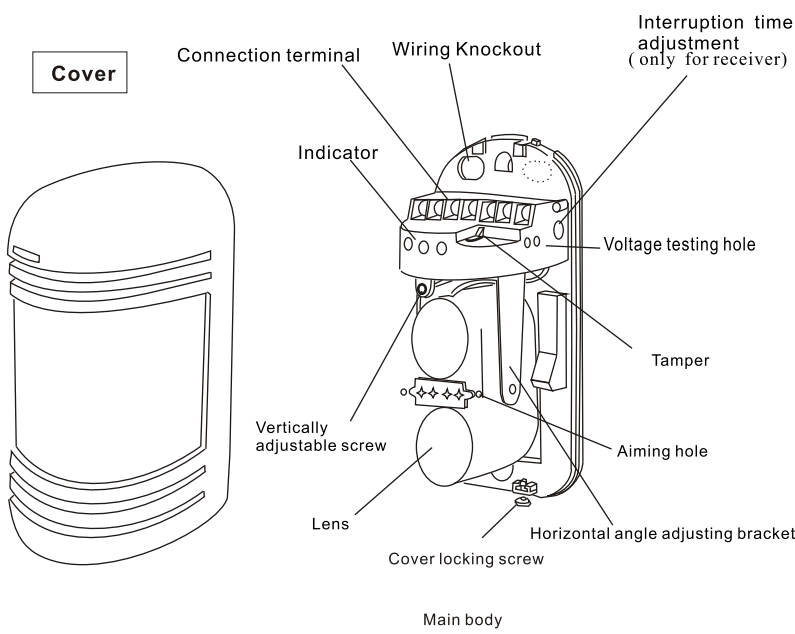

(1) Indicator

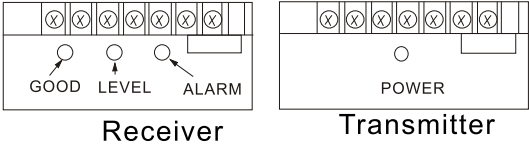

- LEVEL indication lamp (red) Brightness varies, depending on incident level.
- ALARM (red) On indicated alarm
- GOOD indication lamp (green) is ON when beams are aligned, OFF when beams are not aligned.

- (1) Power (green) when the light beam transmitting, the indicator is on.
- (2) Use it when adjust the precision of the optical axis (Refer to the operation instruction)
- (3) Use it when set interruption time (Refer to the operation instruction)

2 Setting notice

Do not mount the detector at following areas:

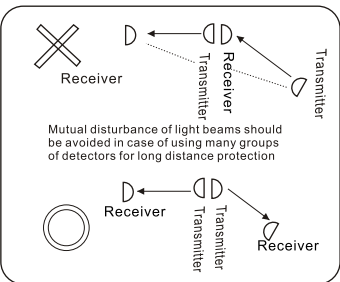
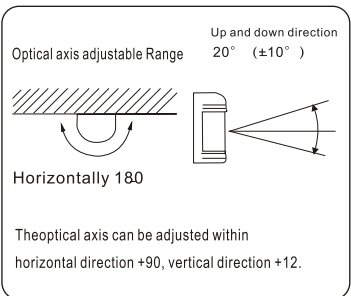
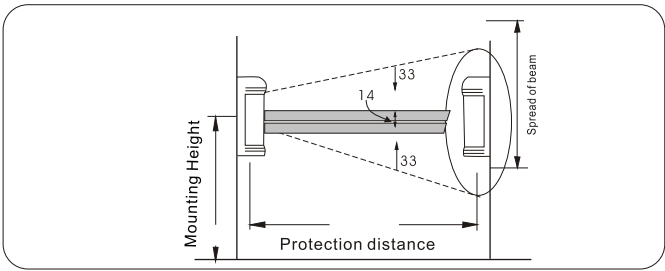
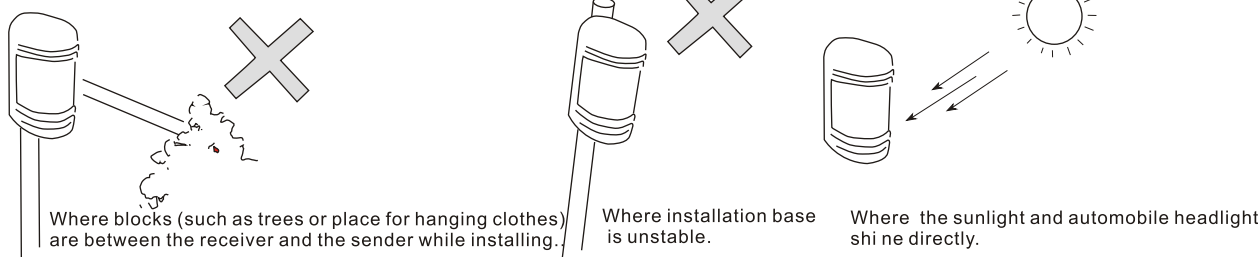

3 Setting Method

1. Loosen the fixed screw and remove the cover.

2. Attach the mounting pattern paper to the wall, mark the installation holes, and make the guide holes.

3. Break the knock-out and pull wire through.

4.. Mount the detector on the wall.

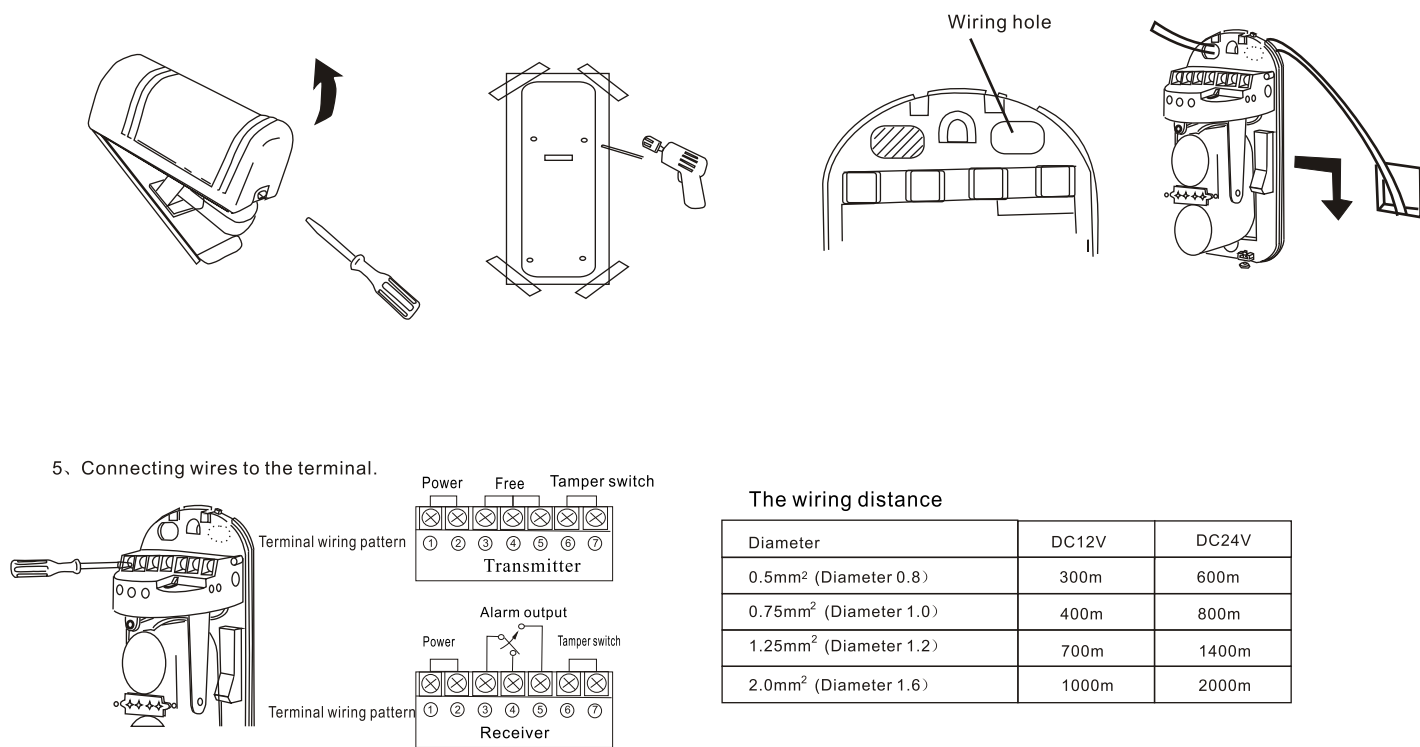

The wiring distance

Diameter	DC12V	DC24V
0.5mm ² (Diameter 0.8)	300m	600m
0.75mm ² (Diameter 1.0)	400m	800m
1.25mm ² (Diameter 1.2)	700m	1400m
2.0mm ² (Diameter 1.6)	1000m	2000m

4 Beam Adjustment

1.Remove the cover, put through power.

2.Observe the aiming effect of the aiming lens at 10cm on the right

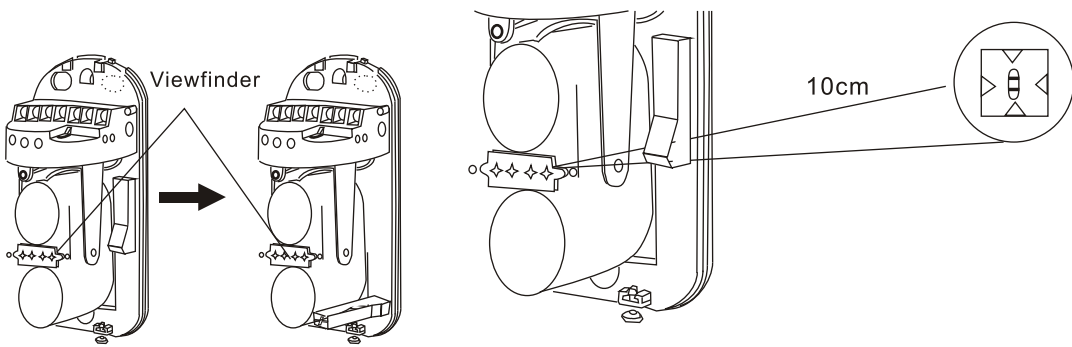

3. Adjust the horizontal adjusting angle screw and horizontal angle adjusting bracket to let the opposite detector in the center of sight lens. The GOOD indication lamp should be on. (Adjust the light axis continuously if the indication lamp is not on.)

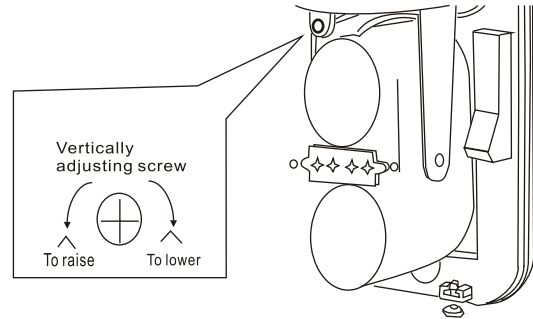

The brighter is red LEVEL indicator light, the higher of the precision of the light axis.

- The best method of the optical axis adjustment- test the output value of the testing hole

- 1.Insert the multi-functional plug to the testing hole (Pay attention to the polarity)
- 2.Adjust the horizontal angle and vertical angle until the testing hole's voltage raises up to max,
- 3.If 1.2v or above voltage cannot be acquired, the transmitter and the receiver should be readjusted.

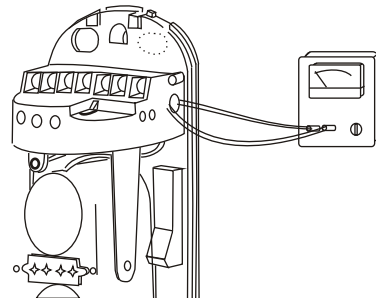

5 Beam interruption time adjustment

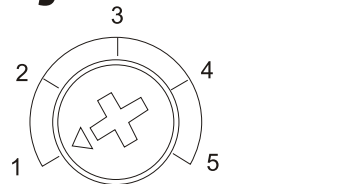

Beam interruption time selection

1. 50msec	2. 306msec	3. 408msec	4&5. 500~700msec
-----------	------------	------------	------------------

6 Operation confirmation

After installation, confirm correct operation by suitable walk tests. Refer to the LED indication of the right form during the walking test.

	Condition	Indication
Transmitter	Transmitting	Green LED is ON
Receiver	Watching	GOOD-LEVEL Indication is ON
	Alarm	Alarm indication lamp is ON

7 Troubleshooting

Symptom	Possible Cause	Remedy
Transmitter LED dose not light.	Improper voltage supplied.	Check the power supply and wiring.
Receiver LED dose not light.	Improper voltage supplied.	Check the power supply and wiring.
Alarm LED dose not light, even when beams are blocked.	1.Beams are reflected to the receiver by other objects. 2. 2 beams are not interdicted simultaneously. 3. Shading light time is too short.	1. Remove the reflecting object or change optical axis direction. 2. Shade 2 beam 3. Prolong the shading time.
When the beams are blocked, the receiver LED lights is ON, but not alarm.	1.Wring is short circuit. 2. Wiring point is not good.	Checking wiring and connection spot.
The alarm indication lamp of receiver is always on.	1. Optical axis is not properly adjusted. 2. There are blocks between the transmitter and receiver. 3. The detector cover or strained slick are dirty.	1. Adjust the optical axis. 2. Remove the blocks. 3. Polish with the soft cloth.
Intermittent alarm	1. Bad wiring. 2. Fluctuant power supply / voltage. 3. Movable blocks between the transmitter and the receiver. 4. The installation base is unstable. 5. Blocked by other moving objects.	1. Check wiring. 2. Check the power supply. 3. Remove the blocks or relocate. 4. Fix the mounting. 5. Adjust the optical axis. 6. Adjust shading time or change installing position.

8 Specification

Range	Outdoor	30m	60m	80m	100m
	Indoor	90m	180m	240m	300m
Beam characteristics		Pulsed infrared dual beams			
Interruption period		50~700msec(selectable)			
Power input		DC12~24V/AC11~18V			
Current consumption		40mA max	55mA max	65mA max	65mA max
Alarm period		2Sec(±1)nominal			
Alarm output		Form C relay (AC/DC30V 0.5A max)			
Tamper switch		N.C.Opens when cover is removed (receiver only)			
Operating temperature		-25℃~+55℃			
Environment humidity		95% max			
Alignment angle		±5° vertical, ±90° horizontal			
Mounting		Wall or pole			
Weight		300g(Both transmitter and receiver)			
Appearance		PC Resin(Black)			

Pole mounting

- 1.Break out the wire hole on the bracket then pull out the wires.
- 2.Remove the cover
- 3.Fix the base plate on the bracket.

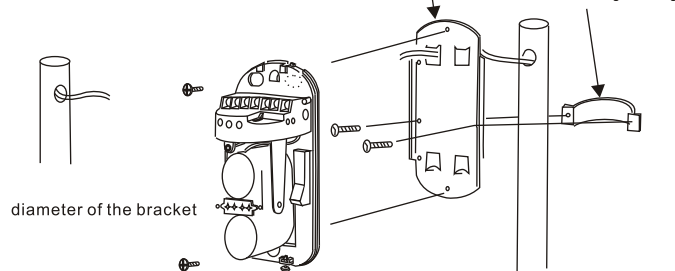

- Back to back installation (Refer to the figure below.)

